

Custom Stripmaster® Wire Stripper

Repair Parts List -- Cat. No. 45-169 thru 45-188

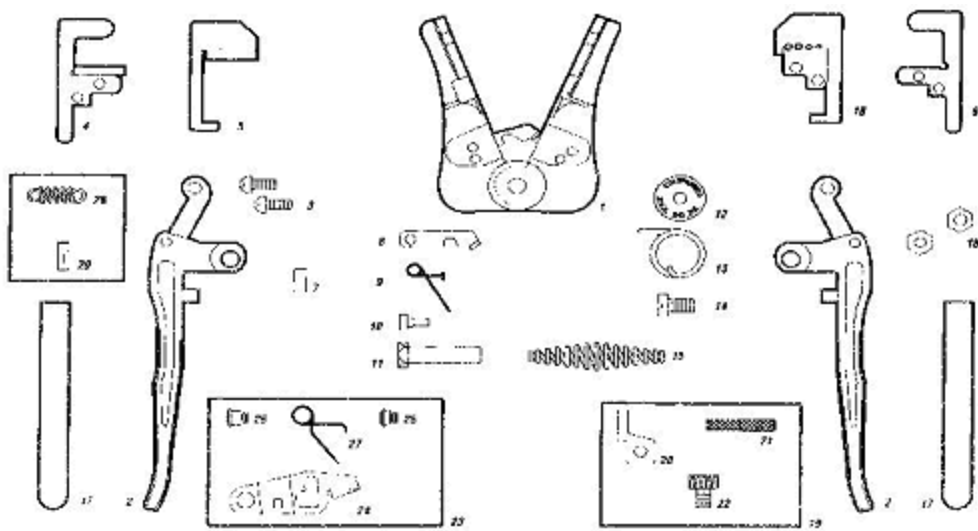

Please contact the factory for parts and repairs. Always include complete description, part number, and nameplate data.

Parts List

Item	# Reqd	Description	Part No.
1	1	Jaw Sub-Assembly*	*LB-1024†
2	2	Handle Sub-Assembly	I-6757RP†
3	2	Gripper Screw (#5-40 x 13/32 w/lockwasher)	355.002
4	1	Stationary Grit Gripper Pad 10-14 AWG	L-5215
4	1	Stationary Grit Gripper Pad 16-30 AWG	L-5217
5	1	Moveable Grit Gripper Pad	L-5212
6	1	Blade Retaining Plate	L-9040
7	1	Latch Pin	281.082†
8	1	Latch	L-8906
9	1	Latch Spring	L-4388
10	1	Latch Stud	L-8973
11	1	Pivot Stud	LB-909
12	1	Pivot Spring Cover	L-5093
13	1	Pivot Spring	L-5092
14	1	Pivot Stud Screw (#8-32 x 3/8, Nylok)	358.015
15	1	Handle Spring	L-4387
16	2	Blade Nut (#5-40, Keps Nut)	374.022
17	2	Handle Sleeve (Black)	LA-4070
17	2	Handle Sleeve (Red)	L-5345

Accessories available separately or with 45-180 thru 45-188

Item	# Req'd	Description	Part No.
19	1	Wire Stop Assembly (includes items 20-22)	L-5270
20	1	Wire Stop	L-5800
21	1	Stop Rod	L-8907
22	1	Thumb Head	1341.037
23	1	Short-Stop Latch Assembly (includes items 24-27)	L-5269
24	1	Latch	K-2272
25	1	Latch Pin	L-5273
26	1	Pivot Pin	L-5272
27	1	Spring	L-5271
28	1	Internal Spring (see repl Frame Assembly)	L-6029†
29	2	Internal Spring Pin	281.064†

* Jaw Sub-Assembly includes left and right jaws with items 7 thru 11.

† Note: For Internal Spring Frames use LB-1025 Jaw Sub Assembly.

I-6758 Handle Sub-Assembly, LB-075 Latch Pin and Items 28 and 29.

Replacement Blades

Wire Gauge	Complete Cat. No.	Complete w/Wire Stop & Short-Stop Latch	Blade Part No.
<i>For General Purpose, Plastic, Fiberglass, etc.</i>			
10-14	45-170	45-180	L-5210
16-26	45-171	45-181	L-5211
26-30	45-172	45-182	L-5436
<i>For Wire Wrapping (Thin Insulation) Solid Wire</i>			
24-30	45-169	--	L-9300
30 only	45-170	--	L-7625
<i>For MIL -W-16878 Type EE 1000V TEFLON® Wire</i>			
10-14	45-173	45-183	L-5562
16-26	45-174	45-184	L-5563
26-30	45-175	45-185	L-5564
<i>For MIL -W-16878 Type E 600V TEFLON® Wire</i>			
10-14	45-176	45-186	L-5559
16-26	45-177	45-187	L-5560
26-30	45-178	45-188	L-5561

*Reg. ™ DuPont.

Note: Contact factory for blade recommendation for other wire types including MIL-W-22759, MIL-W-81381, MIL-W-81044.

TEFLON® is a registered trademark of E.I. du Pont de Nemours and Company.

Replacement Gripper Pads

Surface Type	Moveable Gripper	Stationary Gripper (Thickness)	Gripper Set
Grit*	L-5212	L-5215 (.129")	LB-197
Grit*	L-5212	L-5217 (.156")	LB-198
File	LB-718	LB-719 (.129")	LB-721
File	LB-718	LB-720 (.156")	LB-722
Parallel	LB-727	LB-728 (.129")	LB-730
Parallel	LB-727	LB-729 (.156")	LB-731

*Grit pads are standard for all products.

Note: For wire gauge 10-14, use .129" stationary gripper.

For 16-30 AWG, use .156" gripper.

Replacement Frame Assemblies

Description	Frame Part #
Frame less blades, 10-14 AWG	L-5616
Frame less blades, 16-30 AWG	L-5617
Frame less blades, 10-14 AWG, Wire Stop and Latch	L-5618
Frame less blades, 16-30 AWG, Wire Stop and Latch	L-5619
Frame less blades, 16-30 AWG, Internal Spring (see note)	L-9038
Frame less blades, 10-14 AWG, Internal Spring (see note)	L-9039

Note: Frames with internal springs allow additional blade penetration pressure for difficult and multi-layered insulation types.

Caution

Never plug or mechanically gauge blade holes!

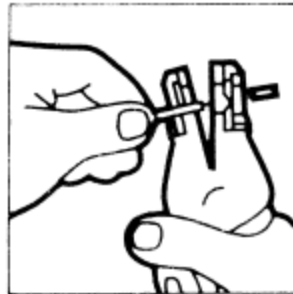
Operating Instructions

1. Insert wire between gripper jaws and position in proper blade hole.

2. Squeeze handles firmly with wire centered in hole to cut insulation.

3. Release pressure on handles and remove wire. Tool ready for next wire.

4. To ensure blade calibration, depress handles until blade surfaces mate. Tighten hex nuts (10 in./lbs). Sample strip. Repeat if necessary.

Maintenance

1. Keep tool clean and free from debris.
2. Insulation material may be removed by washing in cleaning solvent.
3. Apply a light oil to moving parts.

IDEAL INDUSTRIES, INC., Sycamore, IL 60178 U.S.A.
in Canada: IDEAL, Ajax, Ontario L1S 2E1
www.idealindustries.com