

AEC9050  
ONE TUBE RADIO  
MODULE  
(PRELIMINARY DATA)

AEROELECTRIC CONNECTION  
6936 BAINBRIDGE ROAD  
WICHITA, KANSAS 67226  
VOICE: (316) 685-8617  
WEB: AEROELECTRIC.COM

REV -A- 11/15/07

TITLE	PAGE
9050 COVER	1.0

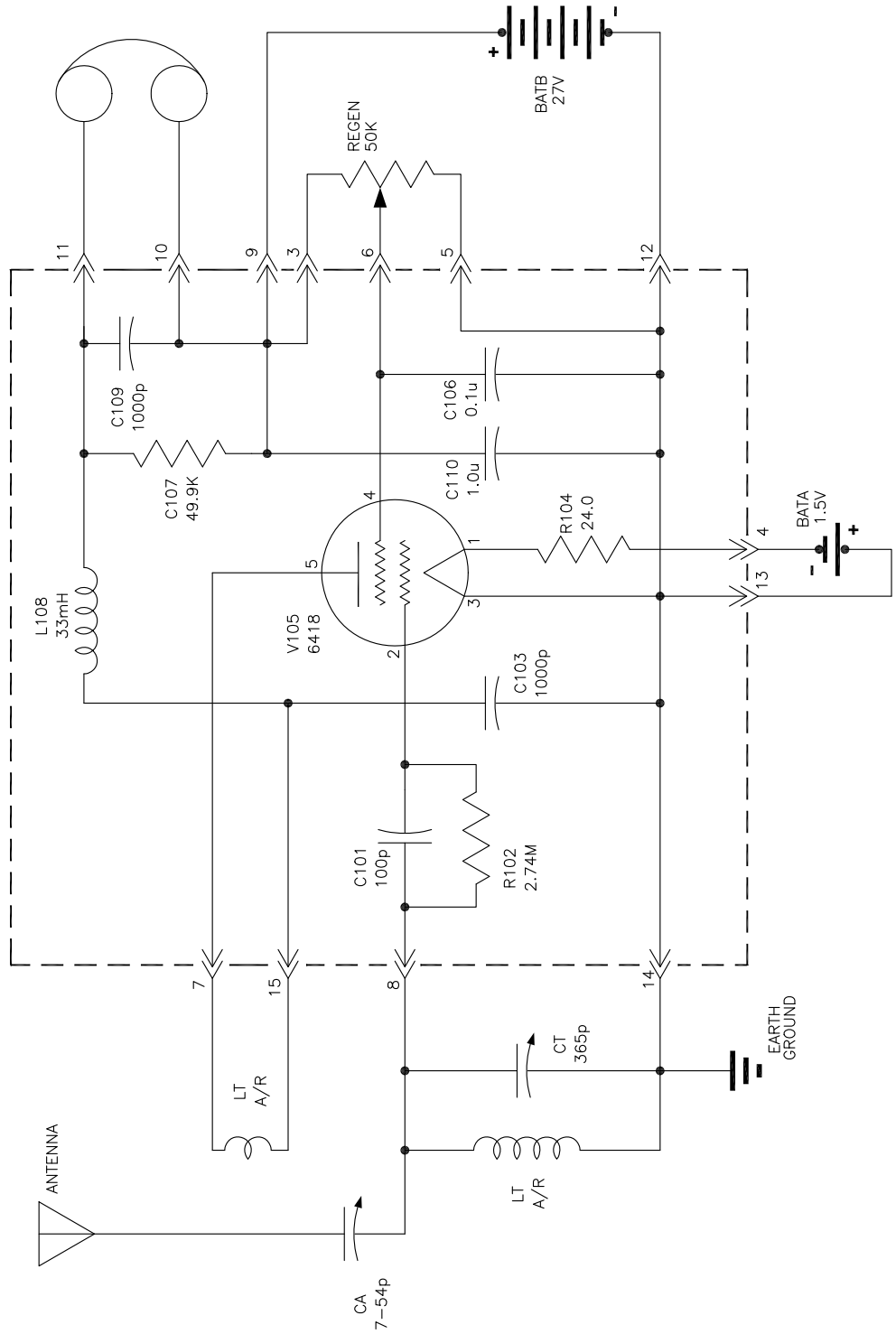

TITLE	PAGE
9050 SCHEMATIC	1.0

		1	P112	171-015-113R021	CONNECTOR, D15P w/SPACERS	NORCOMP
		1	C110	T491A105K025AT	CAP TANT 1.0u 25V 20% SMD1206	KEMET
		1	C109	S/A C106		
			L108	70F332AF-RC	INDUCTOR, 33 mH	JW MILLER
		1	R107	CRCW120647K5FKEA	RES 47.5K, 1/4W, 1%, 1206	VISHAY/DALE
		1	C106	ECJ-3VB1C104K	CAP 0.1u 16V CERAMIC X7R 1206	PANASONIC
		1	V105	6418	VACUUM TUBE, SUB MIN TETRODE	SURPLUS
		1	R104	CRCW120622R0FKEA	RESISTOR, 22 OHM, 1/4W, 1%, 1206	VISHAY/DALE
		2	C103	ECJ-3FB2J102K	CAP 1000p, 630V, X7R 1206	PANASONIC
		1	R102	CRCW12062M74FKEA	RES, 2.74M, 1/4W, 1%, 1206	VISHAY/DALE
			C101	12061A101KAT2A	CAP 100p, 50V, NPO, 1206	AVX
		1	100	9050-300-1A	ECB	AEC
		2	099	6418	SPACER	AEC
		2	098	91251A135	SCREW, CAPHEAD, 4-40 x .125"	McMASTER
		1	097	9011-100-1	ENCLOSURE	AEC
		1	096	9011-280-1	COVER	AEC
				AEC9050	MODULE - ONE TUBE RADIO	AEC
		-1	REF DESIG	PART NUMBER	DESCRIPTION	MFGR/SUPPLIER
					TITLE	PAGE
					BOM - ONE TUBE RADIO MODULE	1.0

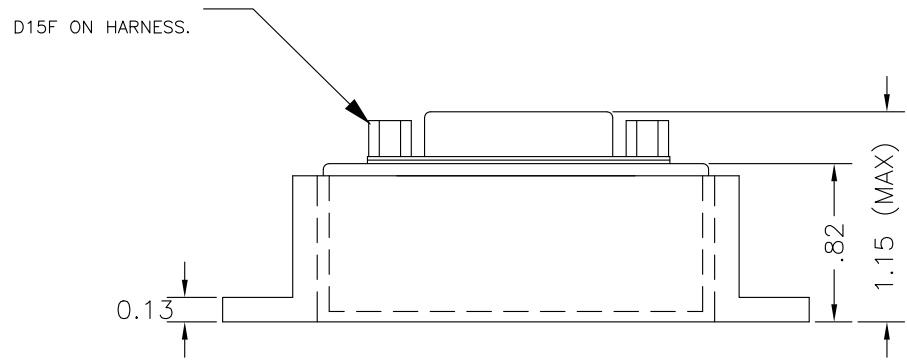
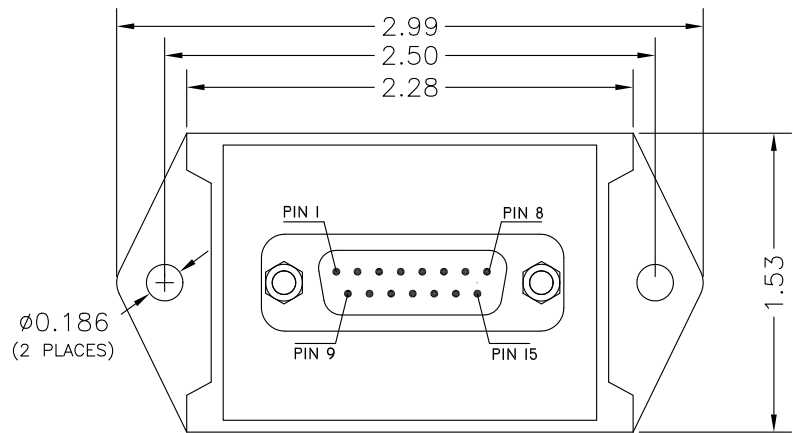

(-1) ONE-TUBE RADIO MODULE

REV -A- 01/22/06	
TITLE	PAGE
9011 ENVELOPE	3.0